

01 02 03 04 05 06 07 08 09 10 11 12 13 14 15 16 17 18 19 20 21 22 23 24 25 26 27 28 29 30 31 32 33 34 35 36 37 38 39 40 41 42 43 44 45 46 47 48 49 50 51 52

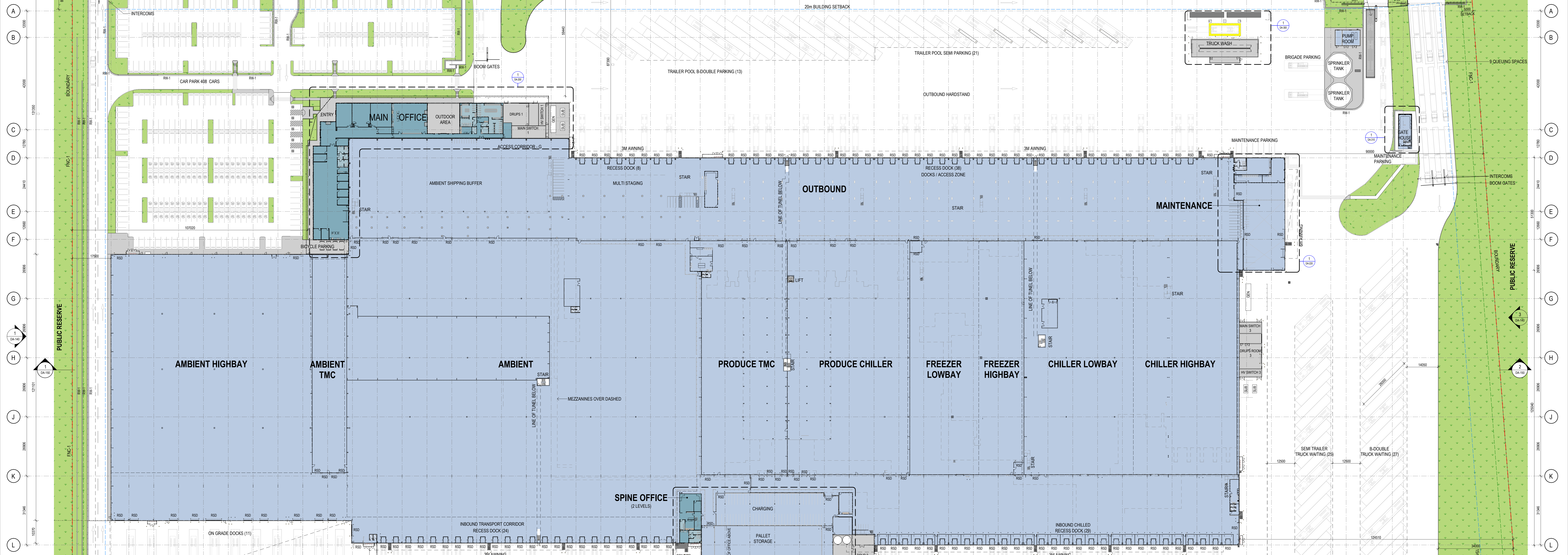

01 02 03 04 05 06 07 08 09 10 11 12 13 14 15 16 17 18 19 20 21 22 23 24 25 26 27 28 29 30 31 32 33 34 35 36 37 38 39 40 41 42 43 44 45 46 47 48 49 50 51 52

- GENERAL NOTE:**
- BOUNDARY LINE
  - LANDSCAPE SETBACK
  - BUILDING SETBACK
  - RETAINING WALL
  - FNC-1, CHAINWIRE FENCING 2100mm HIGH (1.5-0.3m BARBWIRE)
  - FNC-2, PALISADE FENCING 2100mm HIGH
  - PG PEDESTRIAN GATE
  - SG SLIDING GATE
  - Automation CONVEYOR EQUIPMENT TO FUTURE DETAIL
  - Automation RACKING TO FUTURE DETAIL

**Department of Planning,  
Housing and Infrastructure**

NSW GOVERNMENT

Approved Application: **SSD-76913969**

Granted on: **26 February 2026**

Signed: **T.W** Sheet Number: **1** of **23**

Issued Under the Environmental Planning and Assessment Act 1979

**sba**

REVISED DRAWING UPDATES: 01.10.25  
 F02: SBA UPDATED SITE PLAN: 10.28.25  
 F03: SBA REVISIONS: 01.08.25  
 F08: BUILDING SETBACKS ADDED: 17.12.24  
 F18: INBOUND ENTRY UPDATED: FENCING UPDATED: 12.12.24  
 F19: FENCING UPDATED: 11.12.24  
 F21: DA ISSUE: 06.12.24  
 # DESCRIPTION: DATE



**ALDI SYD ADC**  
 475 BADGERYS CREEK ROAD, BRADFIELD

**DA ISSUE**

**SITE PLAN**

DATE: 01.10.25 SCALE: 1:600 @ A0, 1:4800 @ A3 PROJECT NO: 24110 DWG NO: DA-100 REVISION: P23

01 02 03 04 05 06 07 08 09 10 11 12 13 14 15 16 17 18 19 20 21 22 23 24 25 26 27 28 29 30 31 32 33 34 35 36 37 38 39 40 41 42 43 44 45 46 47 48 49 50 51 52



- GENERAL NOTE:**
- BOUNDARY LINE
  - LANDSCAPE SETBACK
  - BUILDING SETBACK
  - RETAINING WALL
  - FNC-1, CHAINWIRE FENCING 2100mm HIGH (1.8-0.3m BARBWIRE)
  - FNC-2, PALISADE FENCING 2100mm HIGH
  - PG PEDESTRIAN GATE
  - SG SLIDING GATE
  - Automation conveyor equipment to future detail
  - Automation racking to future detail

**Department of Planning,  
Housing and Infrastructure**

**NSW GOVERNMENT**

Approved Application: **SSD-76913969**

Granted on: **26 February 2026**

Signed: **T.W** Sheet Number: **2** of **23**

Issued under the Environmental Planning and Assessment Act 1979

**sba**

REV	DESCRIPTION	DATE
01	ISSUE FOR PERMIT	19.09.25
02	ISSUE FOR PERMIT	08.02.24
03	ISSUE FOR PERMIT	26.02.24
04	ISSUE FOR PERMIT	17.03.24
05	ISSUE FOR PERMIT	28.03.24
06	ISSUE FOR PERMIT	15.04.24
07	ISSUE FOR PERMIT	15.04.24



**ALDI SYD ADC**

475 BADGERYS CREEK ROAD, BRADFIELD

**DA ISSUE**

**GROUND FLOOR PLAN**

DATE: 01.10.25 SCALE: 1:600 @ A0, 1:4800 @ A3 PROJECT NO: 24110 DWG NO: DA-101 P8

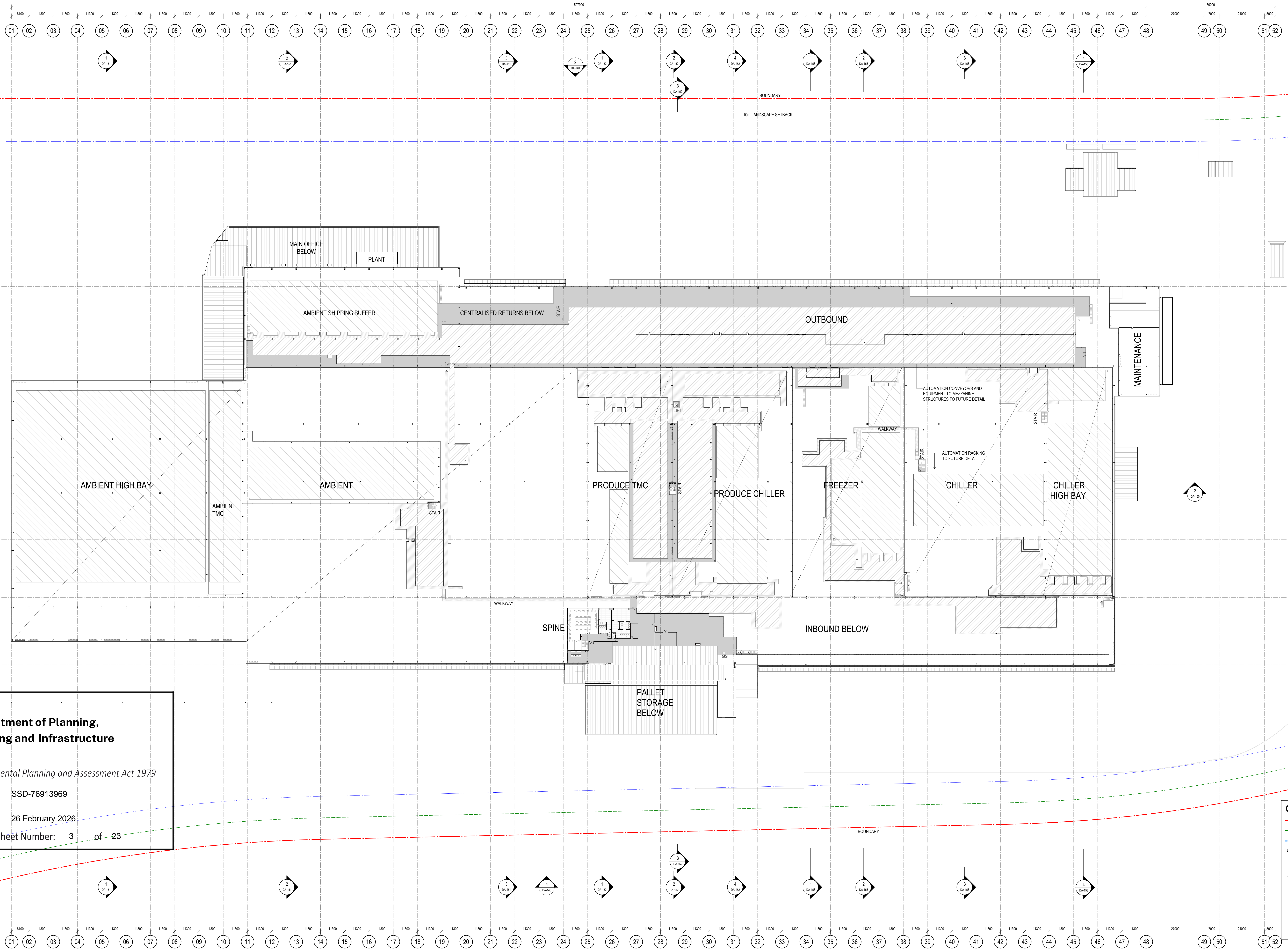

**Department of Planning,  
Housing and Infrastructure**  
 Issued under the Environmental Planning and Assessment Act 1979  
 Approved Application: SSD-76913969  
 Granted on: 26 February 2026  
 Signed: T.W. Sheet Number: 3 of 23

**GENERAL NOTE:**

- BOUNDARY LINE
- LANDSCAPE SETBACK
- BUILDING SETBACK
- RETAINING WALL
- FNC-1, CHAINWIRE FENCING 2100mm HIGH (1.8-0.3m BARBWIRE)
- FNC-2, PALISADE FENCING 2100mm HIGH
- PG PEDESTRIAN GATE
- SG SLIDING GATE
- AUTOMATION CONVEYOR EQUIPMENT TO FUTURE DETAIL
- AUTOMATION RACKING TO FUTURE DETAIL

**DA ISSUE**

REV	DESCRIPTION	DATE
01	ISSUE DRAWING UPDATES	01.10.25
02	ISSUE AMENDMENTS	19.09.25
03	DA ISSUE	08.02.24
04	UPDATED DA SET ISSUE	26.02.24
05	UPDATED PRELIMINARY DA SET ISSUE	17.09.24
06	UPDATED PRELIMINARY DA SET ISSUE	28.08.24
07	UPDATED PRELIMINARY DA SET ISSUE	15.08.24
08	DESCRIPTION	DATE



**ALDI SYD ADC**  
 475 BADGERYS CREEK ROAD, BRADFIELD

<small>THESE DESIGN PLANS &amp; SPECIFICATIONS AND THE COPYRIGHT THEREON ARE THE PROPERTY OF THE APPLICANT AND MUST NOT BE REPRODUCED OR COPIED IN ANY MANNER WITHOUT THE WRITTEN PERMISSION OF THE APPLICANT.</small>	
<small>FOR ALL DIMENSIONS TO BE USED IN REFERENCE TO SCALING, ALL DIMENSIONS MUST BE CHECKED ON SITE.</small>	
<small>THIS DOCUMENT NOT TO BE USED FOR CONSTRUCTION UNLESS SPECIFICALLY AUTHORISED BY THE APPLICANT.</small>	
<b>TITLE</b> MEZZANINE - LEVEL 1	<b>DATE</b> 01.10.25
<b>SCALE</b> 1:600 @ A0 1:4800 @ A3	<b>PROJECT NO.</b> 24110
<b>DWG NO.</b> DA-110	<b>REVISION</b> P8

01 02 03 04 05 06 07 08 09 10 11 12 13 14 15 16 17 18 19 20 21 22 23 24 25 26 27 28 29 30 31 32 33 34 35 36 37 38 39 40 41 42 43 44 45 46 47 48 49 50 51 52

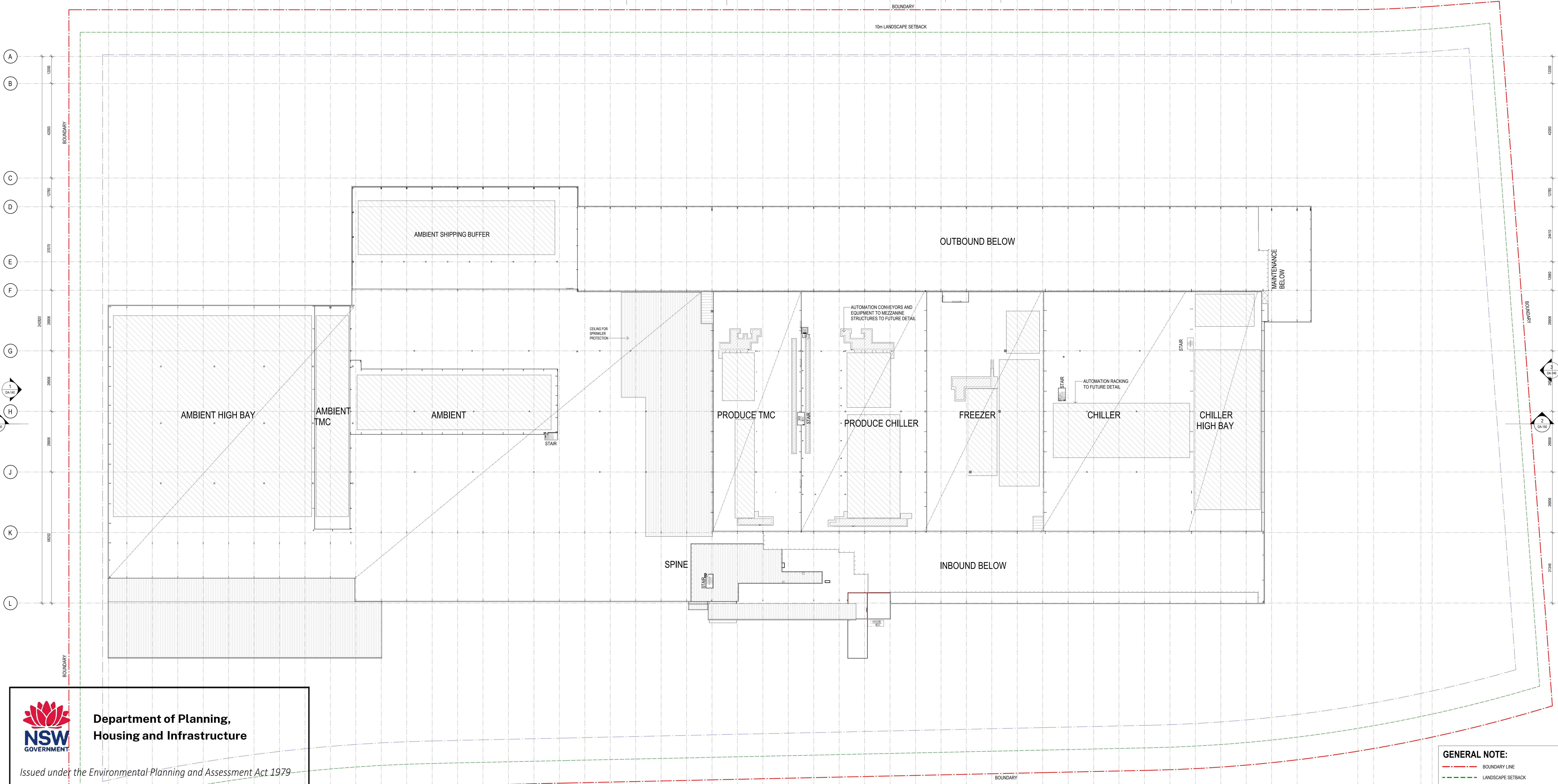

**Department of Planning, Housing and Infrastructure**  
 NSW GOVERNMENT  
 Issued under the Environmental Planning and Assessment Act 1979  
 Approved Application: SSD-76913969  
 Granted on: 26 February 2026  
 Signed: T.W. Sheet Number: 4 of 23

- GENERAL NOTE:**
- BOUNDARY LINE
  - LANDSCAPE SETBACK
  - BUILDING SETBACK
  - RW RETAINING WALL
  - FNC-1, CHAINWIRE FENCING 2100mm HIGH (1.8-0.3m BARBWIRE)
  - FNC-2, PALISADE FENCING 2100mm HIGH
  - PG PEDESTRIAN GATE
  - SG SLIDING GATE
  - AUTOMATION CONVEYOR EQUIPMENT TO FUTURE DETAIL
  - AUTOMATION RACKING TO FUTURE DETAIL

PF	ISSUE AMENDMENTS	19.09.25	CLIENT
P6	DA ISSUE	06.12.24	
P5	UPDATED DA SET ISSUE	28.02.24	
P4	UPDATED PRELIMINARY DA SET ISSUE	17.02.24	
P3	UPDATED PRELIMINARY DA SET ISSUE	28.02.24	
P2	UPDATED PRELIMINARY DA SET ISSUE	11.02.24	
P1	UPDATED PRELIMINARY DA SET ISSUE	07.02.24	
#	DESCRIPTION	DATE	



**ALDI SYD ADC**  
 475 BADGERYS CREEK ROAD, BRADFELD

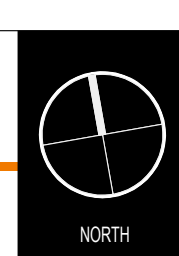

<b>DA ISSUE</b>			
THESE DESIGN PLANS & SPECIFICATIONS AND THE COPYRIGHT THEREON ARE THE PROPERTY OF THE APPLICANT AND MUST NOT BE REPRODUCED OR COPIED IN ANY MANNER WITHOUT THE WRITTEN PERMISSION OF THE APPLICANT.			
FIGURED DIMENSIONS TO BE USED IN PREFERENCE TO SCALING. ALL DIMENSIONS TO BE CHECKED ON SITE.			
THIS DOCUMENT NOT TO BE USED FOR CONSTRUCTION UNLESS EXPRESSLY INDICATED OTHERWISE.			
TITLE	SCALE	PROJECT NO.	DWG NO.
MEZZANINE - LEVEL 2	1:600 @ A0	24110	DA-111
DATE	SCALE	PROJECT NO.	REVISION
19.09.25	1:4800 @ A3	24110	P7

01 02 03 04 05 06 07 08 09 10 11 12 13 14 15 16 17 18 19 20 21 22 23 24 25 26 27 28 29 30 31 32 33 34 35 36 37 38 39 40 41 42 43 44 45 46 47 48 49 50 51 52

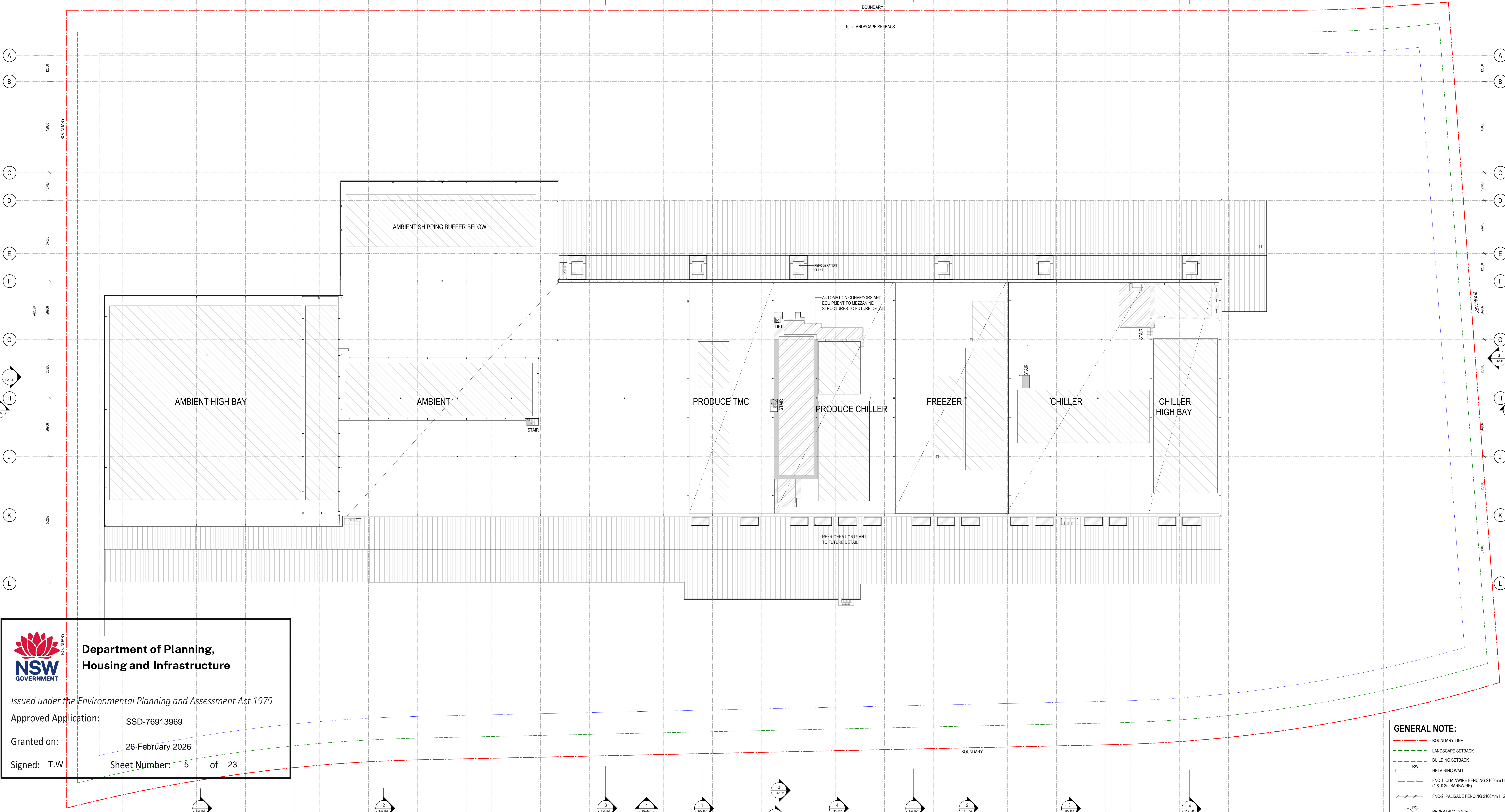

**NSW GOVERNMENT**  
**Department of Planning, Housing and Infrastructure**  
 Issued under the Environmental Planning and Assessment Act 1979  
 Approved Application: **SSD-76913969**  
 Granted on: **26 February 2026**  
 Signed: T.W. Sheet Number: **5** of 23

- GENERAL NOTE:**
- BOUNDARY LINE
  - - - LANDSCAPE SETBACK
  - - - BUILDING SETBACK
  - RW RETAINING WALL
  - FNC-1, CHAINWIRE FENCING 2100mm HIGH (1.8-0.3m BARBWIRE)
  - FNC-2, PALISADE FENCING 2100mm HIGH
  - PG PEDESTRIAN GATE
  - SG SLIDING GATE
  - Automation conveyor equipment to future detail
  - Automation racking to future detail

**sba**



**ALDI SYD ADC**  
 475 BADGERYS CREEK ROAD, BRADFIELD

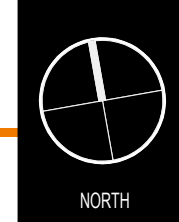

**DA ISSUE**

**MEZZANINE - LEVEL 3**

DATE: 19.09.25 SCALE: 1:600 @ A0 PROJECT NO: 24110 DWG NO: DA-112 REVISION: P7

#	DESCRIPTION	DATE
P7	ISSUE AMENDMENTS	19.09.25
P6	DA ISSUE	06.12.24
P5	UPDATED DA SET ISSUE	28.02.24
P4	UPDATED PRELIMINARY DA SET ISSUE	17.02.24
P3	UPDATED PRELIMINARY DA SET ISSUE	28.08.24
P2	UPDATED PRELIMINARY DA SET ISSUE	11.08.24
P1	UPDATED PRELIMINARY DA SET ISSUE	07.08.24
#	DESCRIPTION	DATE

CLIENT

THESE DESIGN PLANS & SPECIFICATIONS AND THE COPYRIGHT THEREIN ARE THE PROPERTY OF THE ISSUING ENGINEER AND MUST BE USED, REPRODUCED OR COPIED WHOLLY OR IN PART WITHOUT THE WRITTEN PERMISSION OF THE ISSUING ENGINEER.

FOR ALL DIMENSIONS TO BE CHECKED IN REFERENCE TO SCALING. ALL DIMENSIONS TO BE CHECKED IN REFERENCE TO SCALING.

THIS DOCUMENT NOT TO BE USED FOR CONSTRUCTION UNLESS SPECIFICALLY FOR THAT PURPOSE.

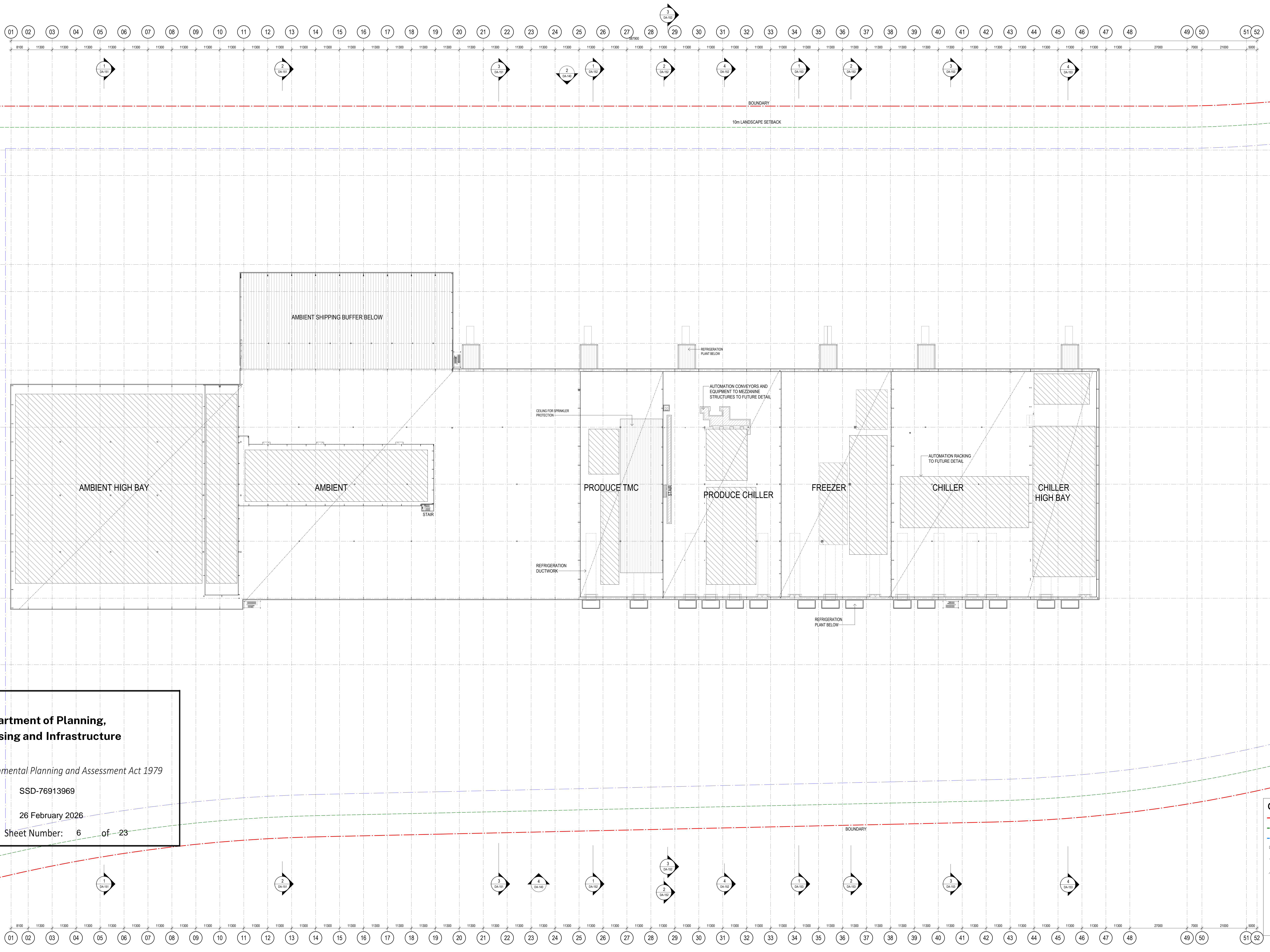



**Department of Planning,  
Housing and Infrastructure**  
 Issued under the Environmental Planning and Assessment Act 1979  
 Approved Application: SSD-76913969  
 Granted on: 26 February 2026  
 Signed: T.W. Sheet Number: 6 of 23

- GENERAL NOTE:**
- BOUNDARY LINE
  - LANDSCAPE SETBACK
  - BUILDING SETBACK
  - RETAINING WALL
  - FNC-1, CHAINWIRE FENCING 2100mm HIGH (1.8-0.3m BARBWIRE)
  - FNC-2, PALISADE FENCING 2100mm HIGH
  - PEDESTRIAN GATE
  - SLIDING GATE
  - AUTOMATION CONVEYOR EQUIPMENT TO FUTURE DETAIL
  - AUTOMATION RACKING TO FUTURE DETAIL

#	DESCRIPTION	DATE
P7	ISSUE AMENDMENTS	19.09.25
P6	DA ISSUE	06.12.24
P5	UPDATED DA SET ISSUE	28.02.24
P4	UPDATED PRELIMINARY DA SET ISSUE	17.02.24
P3	UPDATED PRELIMINARY DA SET ISSUE	28.02.24
P2	UPDATED PRELIMINARY DA SET ISSUE	11.02.24
P1	UPDATED PRELIMINARY DA SET ISSUE	07.02.24
#	DESCRIPTION	DATE

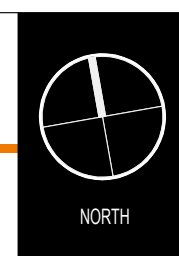

**ALDI SYD ADC**  
 475 BADGERYS CREEK ROAD, BRADFIELD



TITLE			
<b>MEZZANINE - LEVEL 4</b>			
DATE	SCALE	PROJECT NO.	DWG NO.
19.09.25	1:600 @ A0 1:4800 @ A3	24110	DA-113 P7
		REVISION	

**DA ISSUE**

LEGEND	
BG	BOX GUTTER
EG	EAVES GUTTER
MDR	METAL ROOF SHEETING
TRS	TRANSLUCENT SHEETING
SP	SOLAR PANELS
EJ	EXPANSION JOINT
MP	INDICATIVE LOCATION OF MECHANICAL PLANT ON ROOF
MBC	METAL BARGE CAPPING

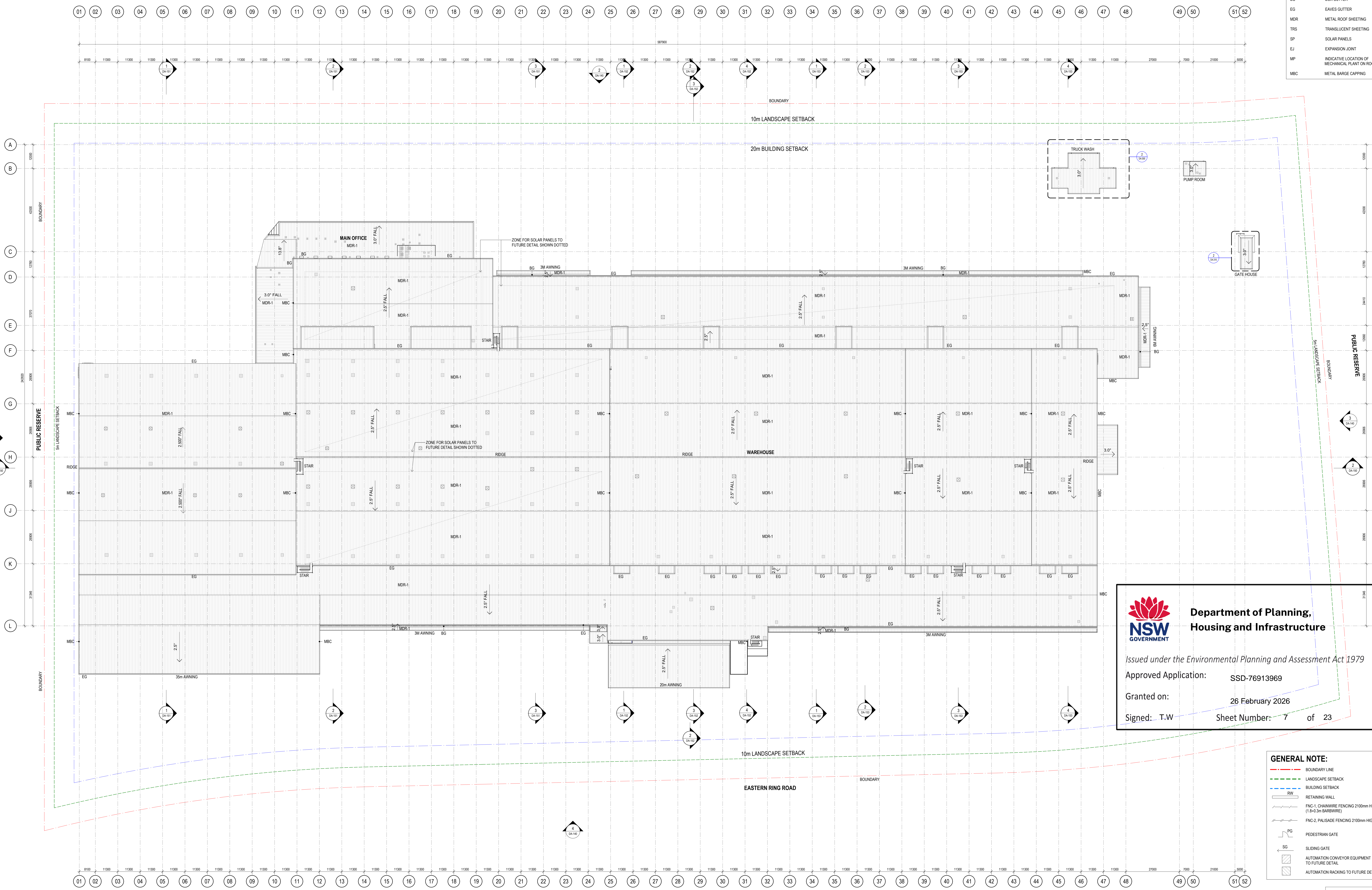

**Department of Planning,  
Housing and Infrastructure**

*Issued under the Environmental Planning and Assessment Act 1979*

Approved Application: **SSD-76913969**

Granted on: **26 February 2026**

Signed: **T.W** Sheet Number: **7** of **23**

**GENERAL NOTE:**

- BOUNDARY LINE
- LANDSCAPE SETBACK
- BUILDING SETBACK
- RETAINING WALL
- FNC-1, CHAINWIRE FENCING 2100mm HIGH (1.8-0.3m BARB WIRE)
- FNC-2, PALISADE FENCING 2100mm HIGH
- PEDESTRIAN GATE
- SLIDING GATE
- AUTOMATION CONVEYOR EQUIPMENT TO FUTURE DETAIL
- AUTOMATION RACKING TO FUTURE DETAIL

REV	DESCRIPTION	DATE
P10	ISSUE AMENDMENTS	19.09.25
P9	DA ISSUE	06.12.24
P8	UPDATED DA SET ISSUE	28.03.24
P7	UPDATED PRELIMINARY DA SET ISSUE	28.03.24
P6	UPDATED PRELIMINARY DA SET ISSUE	15.08.24
P5	UPDATED PRELIMINARY DA SET ISSUE	07.03.24
P4	PRELIMINARY DA SET ISSUE	25.07.24
#	DESCRIPTION	DATE



**ALDI SYD ADC**  
475 BADGERYS CREEK ROAD, BRADFIELD

TITLE		DATE		SCALE		PROJECT NO.		DWG NO.		REVISION	
ROOF PLAN		19.09.25		1:600 @ A0 1:4800 @ A3		24110		DA-120		P10	

**DA ISSUE**